



ROTO-SHAKER Screener



Andritz Sprout Roto-Shaker Screener

uses a proven gyratory-reciprocating screening action that delivers both high capacity and accurate separations. The gyratory screening action at the inlet quickly stratifies and distributes material over the entire screen surface.



Andritz Sprout Roto-Shaker Screeners are available in eight model sizes with one to four screening surfaces. The Roto-Shaker can be floor mounted, on a stand or suspended by cables. The unit requires very little headroom, making installation easy in limited spaces.

The Roto-Shaker screener is ruggedly designed - built for continuous, trouble-free operation for even the toughest applications.



The computer balanced dynamic drive provided efficient and low maintenance operation while minimizing structural vibrations.

Every Roto-Shaker is backed by our promise for quick dependable service and quality replacement parts..

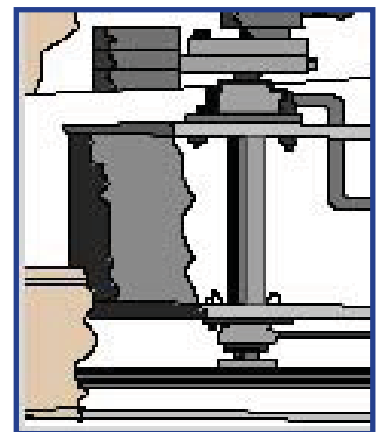

The Simple V-Belt drive, with only three bearings and fewer moving components reduces operating and maintenance costs.

Andritz Sprout Roto-Shaker Screener

General

The General Roto-Shaker is equipped with:

Wooden Frames for Economical Operation

Easy Handling and Quick Changes with the Sectionalized Screen Frames

A Diverter Valve discharge option is available. Contact our Representatives for more information.

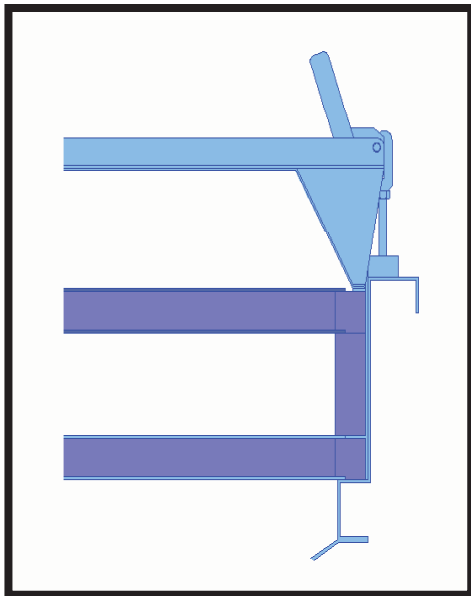

Wooden Screen Frame

Industrial

The Industrial Roto-Shaker is equipped with:

Heavy Duty Segmented Screen Frames

Carbon Steel or Stainless Steel Construction

Increased Screen Life with Spring Tensioned Hook-Up Strip Screen attachment

Easy Adjustment, Great Efficiency.

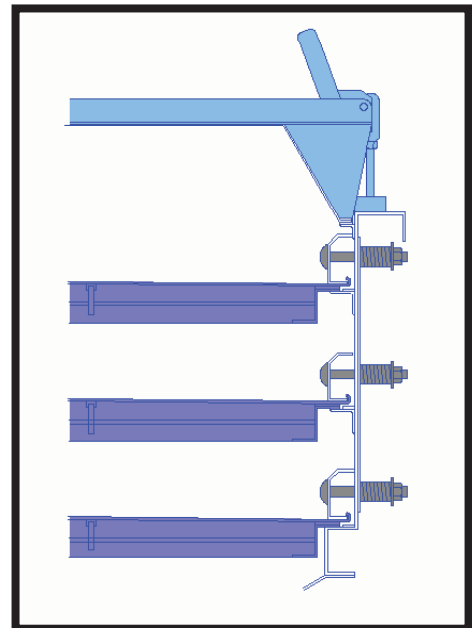

Heavy Duty Frames

Typical Applications:

Granulated Sugar, Silica products, Pet Foods, Grain cleaning, Vegetable Grading, Ammonium Nitrate, Plastic Pellets and powders, Food Products, Wood Chips, Pigments, Ground Corn Cob, Fish food/meal, Aluminum Scrap, Dried Apples, Cracked Corn cleaning, Fertilizer, Sand, Carbon Black, Urea, Graphite, Meat/Bone Meal, Ascorbic Acid, Detergents, Clay, Citrus Pulp, Sodium Bicarbonate, Ground Glass, Feed Ingredients, Gunpowder, Mica, Petroleum Coke, Coffee Beans, Composted Humus, Foods, Meal Powder, PVC powder and more.

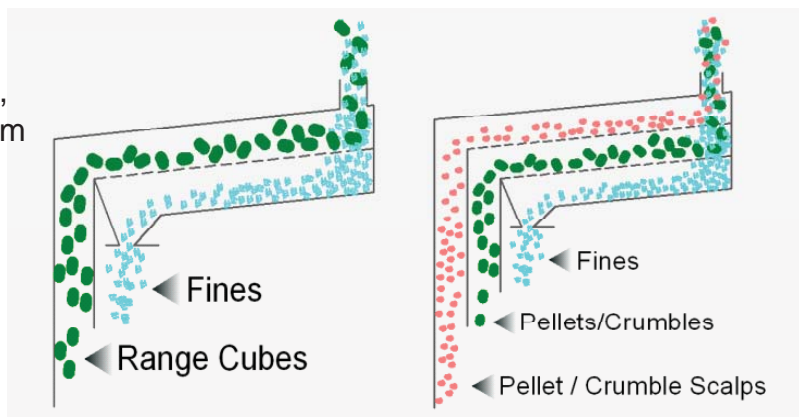

Typical Operation

Roto-Shaker Screeners: High Capacity Efficient Operation for Tough Screening Applications

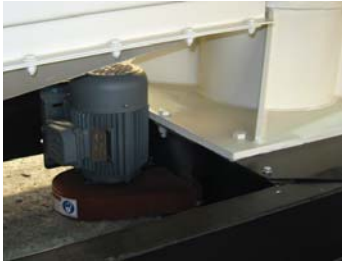

Adjustable Foot-Mounted Motor



Rugged Fiberglass Springs increases screen utilization and efficiency

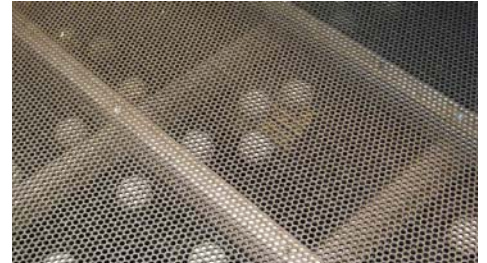

Specially Formulated Rubber Ball Cleaners. High Bounce and Chemical Resistant

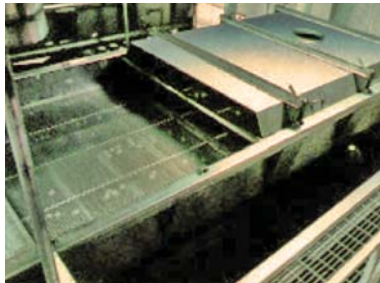

Easy Maintenance with Segmented Screen Decks and Top Cover



Fast and Easy Screen changes with our Quick-Release Clamps.



Ready for Cable Suspension for space concerns and/or vibration reduction

Model Size	HP	Number of Screens	Inlet Dia.	Discharge equal to Circumf. Circle	Approx. Shipping Weight LB.	Capacity Tons Per Hour Pellets	Capacity Tons Per Hour Crumbles	Capacity Tons Per Hour Cubes
2 x 4	1	1	6"	6"	1,200	7	5	3
	1	2	6"	6"	2,000			
	1	3	6"	6"	2,300			
2 1/2 x 6	1	1	8"	8"	2,000	14	8	5
	1	2	8"	8"	2,600			
	1	3	8"	8"	3,000			
	1 1/2	4	8"	8"	3,500			
3 1/2 x 7	1 1/2	1	8"	8"	3,000	25	15	10
	1 1/2	2	8"	8"	3,600			
	1 1/2	3	8"	8"	4,100			
	3	4	8"	8"	4,500			
4 1/2 x 8	3	1	12"	12"	4,400	36	24	15
	3	2	12"	12"	4,900			
	3	3	12"	12"	5,100			
	5	4	12"	12"	5,500			
5 x 10	5	1	12"	12"	6,800	50	34	20
	5	2	12"	12"	7,000			
	5	3	12"	12"	7,400			
	7 1/2	4	12"	12"	8,000			
5 x 12	5	1	12"	12"	7,000	60	37	25
	5	2	12"	12"	7,200			
	5	3	12"	12"	7,600			
	7 1/2	4	12"	12"	8,200			
6 x 14	7 1/2	1	16"	16"	8,200	85	55	35
	7 1/2	2	16"	16"	8,500			
	10	3	16"	16"	10,000			

Subject to change without notice. Dimensions are approximate; for installation request certified drawings.



Rugged Channel Construction means reducing vibrational stress

Capacities are based on the General model and obtaining maximum cleanup. If efficiencies of separation can be compromised, higher screening rates would be obtainable.

Model Size	Number of Screens	A	B	C	D	E	F	G	Dia H	J	K
2 x 4	1	7' 9"	36 1/2"	18 1/4"	36"	41"	6' 3 3/4"	8"	6"	10 5/8"	
	2	8' 3"	36 1/2"	18 1/4"	36"	41"	6' 1 3/4"	8"	6"	7 3/8"	
	3	8' 8 3/4"	36 1/2"	18 1/4"	37 3/4"	42"	6' 0 1/8"	8"	6"	3 5/8"	
2 1/2 x 6	1	9' 10 1/2"	44"	22"	38 1/4"	42 1/8"	8' 2 1/2"	10"	8"	9 5/8"	
	2	10' 6 1/2"	44"	22"	38 1/4"	42 1/8"	8' 0 1/2"	10"	8"	6 3/8"	
	3	11' 9"	44"	22"	41 1/4"	42 1/8"	8' 4 1/8"	10"	8"	2 3/8"	
	4	13' 4"	60"	30"	49"	48 5/8"	8' 11 1/2"	10"	8"	2 1/8"	
3 1/2 x 7	1	11' 7 1/2"	60"	30"	40 1/4"	49 1/2"	10' 0 1/4"	10"	8"	9 7/8"	
	2	12' 6"	60"	30"	40 1/4"	49 1/2"	10' 0"	10"	8"	7 1/2"	
	3	13' 6"	60"	30"	43 3/4"	49 3/4"	9' 11 3/4"	10"	8"	2 1/2"	
	4	14' 8 1/2"	65"	32 1/2"	48 5/8"	54 7/8"	10' 4 5/8"	10"	8"	1 1/8"	
4 1/2 x 8	1	13' 0"	65"	32 1/2"	45 7/8"	56 5/8"	11' 6 1/4"	8"	15 1/4"	14 5/8"	6 1/2"
	2	13' 7 3/4"	65"	32 1/2"	45 7/8"	56 7/8"	11' 6"	8"	15 1/4"	12"	6 1/2"
	3	14' 3 1/2"	65"	32 1/2"	45 7/8"	56 7/8"	11' 5 3/4"	8"	15 1/4"	7"	6 1/2"
	4	15' 5 1/2"	72 3/4"	36 3/8"	55 7/8"	57 7/8"	11' 6"	8"	15 1/4"	7 1/2"	6 1/2"
5 x 10	1	15' 2"	72 3/4"	36 3/8"	53"	58 7/8"	13' 8 1/2"	8"	15 1/4"	18"	6 1/2"
	2	15' 10"	72 3/4"	36 3/8"	53"	58 7/8"	13' 8 1/2"	8"	15 1/4"	16 1/4"	6 1/2"
	3	16' 8"	72 3/4"	36 3/8"	55 3/4"	60 7/8"	13' 8 3/4"	8"	15 1/4"	12"	6 1/2"
	4	18' 0"	85"	42 1/2"	57 5/8"	61 7/8"	14' 2 1/8"	8"	15 1/4"	6 7/8"	6 1/2"
5 x 12	1	17' 2"	72 3/4"	36 3/8"	53"	62 7/8"	15' 8 1/2"	8"	15 1/4"	16 3/4"	6 1/2"
	2	17' 10"	72 3/4"	36 3/8"	53"	63 7/8"	15' 8 1/2"	8"	15 1/4"	14 1/2"	6 1/2"
	3	18' 6"	72 3/4"	36 3/8"	55 7/8"	64 7/8"	15' 8 1/8"	8"	15 1/4"	10 1/2"	6 1/2"
	4	19' 10"	85"	42 1/2"	59"	65 7/8"	16' 0"	8"	15 1/4"	4 7/8"	6 1/2"
6 x 14	1	18' 8 1/2"	85"	42 1/2"	54 3/4"	66 7/8"	17' 11 7/8"	10"	20 1/2"	15 3/4"	8 1/2"
	2	20' 8 1/4"	85"	42 1/2"	54 3/4"	67 7/8"	17' 11 7/8"	10"	20 1/2"	12 7/8"	8 1/2"
	3	21' 6 3/4"	85"	42 1/2"	57 3/4"	68 7/8"	17' 11'	10"	20 1/2"	9"	8 1/2"

Subject to change without notice. Dimensions are approximate; for installation request certified drawings.

ROTO-SHAKER SCREENER TECHNICAL DATA

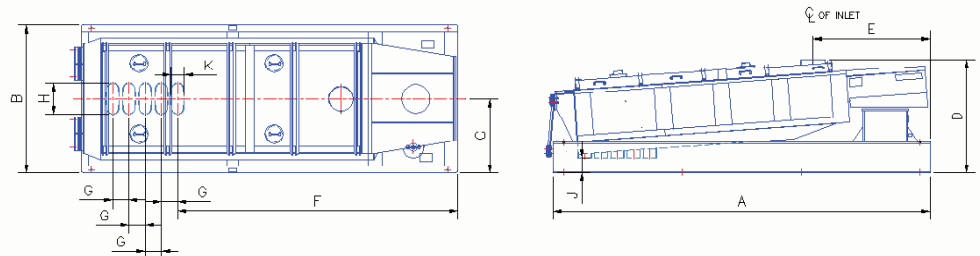

ANDRITZ SPROUT ALSO OFFERS THE ROTO-SHAKER SCREENERS WITH:

- ▶ **Diverter Valve Discharge** sends product to two different locations
- ▶ **Receiving Scalper Model** for high capacity scalping of foreign material on a single screen sifter.

To discuss your applications, request a quote or for more information contact our Technical Representatives at **1-800/446-8629. Visit andritz-sprout.com**

Andritz Sprout's registered Trademark, service marks, word marks, and logos, including Andritz Sprout may not be used or reproduced without permission. Any individual, organization or company wishing to use Andritz Sprout and trademarks must obtain the right to do so in writing from Andritz Sprout.

Andritz Sprout A/S · Tel. +45 72160 300 · andritzsprout.dk@andritz.com · **Andritz Sprout B.V.** The Netherlands · Tel. +31 40 2627777 · andritzsprout.nl@andritz.com · **Andritz Sprout S.A.S.** France · Tel. 33247506364 · andritzsprout.fr@andritz.com · **Andritz Sprout Ltd.** England · Tel. +44 1482825119 · andritzsprout.uk@andritz.com · **Andritz Sprout** eine Zweigniederlassung der Andritz GmbH Germany · Tel. +49 2104 9197-0 · andritzsprout.de@andritz.com · **Andritz Sprout** DIVISION OF ANDRITZ INC. USA · Tel. +1 5705468211 · andritzsprout.us@andritz.com · **Andritz Sprout** Venezuela · Venezuela · Tel. +58 241 8422515 · andritzsprout.ve@andritz.com · **Andritz Sprout** Mexico · Mexico · Tel. +52 (229) 178 3669 · andritzsprout.mx@andritz.com · **Andritz Sprout** do Brazil Ltda. Brazil · Tel. +55 51 3333 0128 · andritzsprout.br@andritz.com · **Andritz Sprout** Chile Ltda. Chile · Tel.: +56 2214 5711 · andritzsprout.cl@andritz.com · **Andritz Sprout** DIVISION OF ANDRITZ PTY LTD. Australia · Tel. +61 3 8795 9800 · andritzsprout.au@andritz.com · **Andritz Sprout** DIVISION OF ANDRITZ TECHNOLOGIES LTD. P.R. China · Tel: +86 21 64670285 · andritzsprout.cn@andritz.com